

REVISIONS							
ZONE	LTR.	DESCRIPTION	DATE	ECN	BY	CKD	APVD
-	-	INITIAL RELEASE	12/15/15	-	TB	-	-
-	B	UPDATED TO NEW STANDARDS	01/25/16	-	-	-	-
-	C	UPDATED NOTES	06/0216	-	-	-	-

*NON-NTEP

PERFORMANCE SPECIFICATIONS:

- CAPACITIES: 100LB, 200LB, 250LB, 300LB, 500LB, 750LB, 1K, 1.5K, 2K, 2.5K, 3K, 5K, 10K,
- RATED OUTPUT: 3.00 mV/V ±0.1%
- SAFE OVERLOAD: 150% FS
- EXCITATION VOLTAGE: 10-20V AC/DC
- INPUT RESISTANCE: 385 ±10 OHMS
- OUTPUT RESISTANCE: 350 ±3 OHMS
- ZERO BALANCE: ±1.00% FS
- SEAL TYPE: ENVIRONMENTALLY SEALED, IP67
- NON-LINEARITY: ±0.03% FS
- HYSTERESIS: ±0.02% FS
- REPEATABILITY: ±0.01% FS
- CREEP: ±0.02% FS
- NTEP RATED
- CLASS 111L 10,000 DIVISION, SINGLE CELL
- COMPENSATED TEMPERATURE RANGE: -10°C - +40°C
- TEMPERATURE EFFECT ON ZERO: ±0.0027%/FS/°C
- TEMPERATURE EFFECT ON OUTPUT: ±0.0015%/FS/°C
- INSULATION RESISTANCE: >5000 MEGOHMS
- LOAD CELL CABLE: 4 CONDUCTOR, 20 FT
- LOAD CELL WIRING:
GREEN +EXC
BLACK -EXC
WHITE +SIG
RED -SIG
BRAID/YELLOW: SHIELD
- FM APPROVED

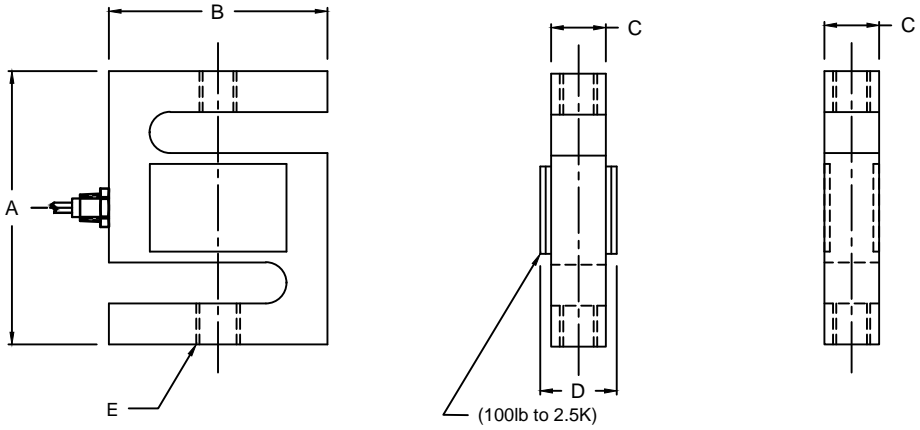

RATED CAPACITY	DIMENSIONS				
	A	B	C	D	E
100lb-300lb	2.50	2.00	0.50	0.75	1/4-28UNF
500lb-2.5K	2.50	2.00	0.75	1.00	1/2-20UNF
3K	4.00	3.00	1.00	-	1/2-20UNF
5K-10K	4.00	3.00	1.00	-	3/4-16UNF

"DO NOT ALTER WITHOUT AGENCY NOTIFICATION"

COTI GLOBAL SENSORS, INC.

CGSB-SS-1 S-BEAM
NTEP LOAD CELL

	THIS DRAWING USES THIRD ANGLE PROJECTION		APPROVALS	DATE	SCALE SIZE PART/DRAWING NO. REV. NONE B DOD-CGSB-SS-1 C MODEL CGSB SHEET 1 OF 1
			DRAWN: TB	12/15/15	
			CHECKED: MB	12/15/15	
			ENGINEER: DMH	12/15/15	
THIS DOCUMENT CONTAINS PROPRIETARY INFORMATION AND SUCH INFORMATION MAY NOT BE REPRODUCED OR DISCLOSED FOR ANY PURPOSE OR USED TO PRODUCE THE ARTICLE OR SUBJECT WITHOUT WRITTEN PERMISSION FROM COTI GLOBAL SENSORS, INC.		TOLERANCES UNLESS OTHERWISE SPECIFIED .XX±.01 .XXX±.005 FRACTIONS±1/16" ANGLES: ±1/2°	APPROVED: AA	12/15/15	
			MATERIAL	STAINLESS STEEL	