

REVISIONS							
ZONE	LTR.	DESCRIPTION	DATE	ECN	BY	CKD	APVD
-	-	INITIAL RELEASE	06/15/11	-	-	-	-

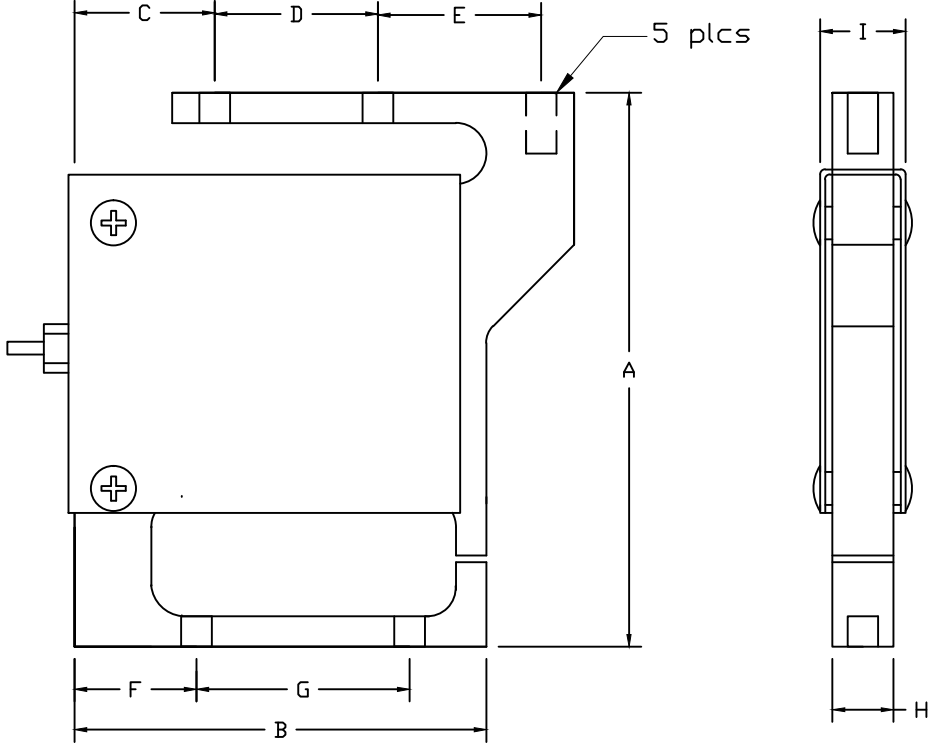

- PERFORMANCE SPECIFICATIONS:**
1. CAPACITIES: 7LB, 15LB & 20LB
 2. RATED OUTPUT: 1.7 mV/V +/-10%
 3. SAFE OVERLOAD: 150% FS
 4. EXCITATION VOLTAGE: 10-15V AC/DC
 5. INPUT RESISTANCE: 385 ±10 OHMS
 6. OUTPUT RESISTANCE: 350 ±3 OHMS
 7. ZERO BALANCE: ±1.00% FS
 8. SEAL TYPE: ENVIRONMENTALLY SEALED.
 9. COMPENSATED TEMPERATURE RANGE: -10°C - +40°C
 10. TEMPERATURE EFFECT ON ZERO: ±0.02%FS/10°C
 11. TEMPERATURE EFFECT ON OUTPUT: ±0.02%FS/10°C
 12. INSULATION RESISTANCE: >5000 MEGOHMS
 13. LOAD CELL CABLE: 4 CONDUCTOR, 10 FT
 14. LOAD CELL WIRING:
 - RED +EXC
 - BLACK -EXC
 - GREEN +SIG
 - WHITE -SIG
 - BRAID/YELLOW: SHIELD
 15. FM APPROVED

RATED CAPACITY	DIMENSIONS										
	A	B	C	D	E	F	G	H	I	J	
7LB-20LB	4.55	3.38	1.15	1.34	1.34	1.00	1.75	0.50	0.70	1/4-28UNF	

'DO NOT ALTER WITHOUT AGENCY NOTIFICATION'

COTI GLOBAL SENSORS, INC.

CG-65029
SINGLE POINT LOAD CELL

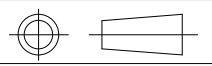

THIS DRAWING USES THIRD ANGLE PROJECTION

THIS DOCUMENT CONTAINS PROPRIETARY INFORMATION AND SUCH INFORMATION MAY NOT BE REPRODUCED OR DISCLOSED FOR ANY PURPOSE OR USED TO PRODUCE THE ARTICLE OR SUBJECT WITHOUT WRITTEN PERMISSION FROM COTI GLOBAL SENSORS, INC.

TOLERANCES UNLESS OTHERWISE SPECIFIED
BY Y&B
COTI GLOBAL SENSORS, INC.

APPROVALS		DATE
DRAWN:	DH	06/15/11
CHECKED:	MB	06/15/11
ENGINEER:	DH	06/15/11
APPROVED:	AA	06/15/11

MATERIAL
STAINLESS STEEL

SCALE	SIZE	PART/DRAWING NO.	REV.
NONE	B	DOD-CG-65029	-
MODEL CG-65029		SHEET 1 OF 1	