

REVISIONS							
ZONE	LTR.	DESCRIPTION	DATE	ECN	BY	CKD	APVD
-	-	INITIAL RELEASE	10/01/08	-	-	-	-
-	A	REMOVE 2.00 mV/V	2/09/10	-	-	-	-
-	C	REMOVE 50K; ADD 50KSE	09/11/12	-	FR	AA	AA
3A	D	REM (3) 0.038; ADD(3) 0.38	03/12/13	-	FR	AA	AA

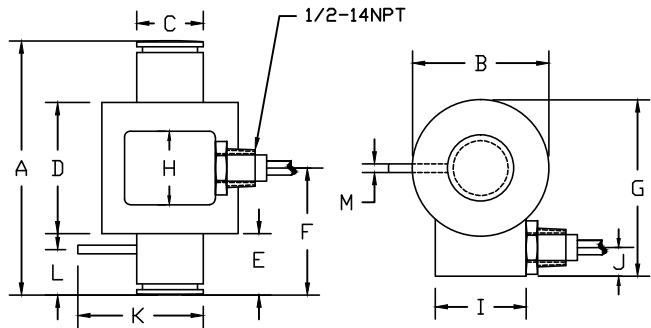

PERFORMANCE SPECIFICATIONS:

- CAPACITIES: 50KSE, 50KLE, 100K LB
- RATED OUTPUT: 1.8 mV/V ±0.1%
- SAFE OVERLOAD: 150% FS
- EXCITATION VOLTAGE: 10-20V AC/DC
- INPUT RESISTANCE: 1080 ±10 OHMS
- OUTPUT RESISTANCE: 1000 ±5 OHMS
- ZERO BALANCE: ±1.00% FS
- SEAL TYPE: HERMETICALLY SEALED, IP68
- NON-LINEARITY: ±0.03% FS
- HYSTERESIS: ±0.02% FS
- REPEATABILITY: ±0.01% FS
- CREEP: ±0.02% FS
- NTEP RATED
- CLASS 111 L 10,000 DIVISION, MULTIPLE CELL
- COMPENSATED TEMPERATURE RANGE: 0°C - +30°C
- TEMPERATURE EFFECT ON ZERO: ±0.0027%FS/°C
- TEMPERATURE EFFECT ON OUTPUT: ±0.0015%FS/°C
- INSULATION RESISTANCE: >5000 MEGOHMS
- LOAD CELL CABLE: 4 CONDUCTOR BRAIDED, 50 FT
- LOAD CELL WIRING:

- GREEN +EXC
- BLACK -EXC
- WHITE +SIG
- RED -SIG
- BRAID/YELLOW: SHEILD

21. FM APPROVED

RATED CAPACITY	DIMENSIONS												
	A	B	C	D	E	F	G	H	I	J	K	L	M
50KSE	6.00	3.00	1.46	2.88	1.56	3.00	3.88	1.62	2.00	0.50	2.88	1.00	0.38
50KLE	7.56	3.00	1.46	2.88	2.34	3.78	3.88	1.62	2.00	0.50	2.88	1.00	0.38
100K	8.86	3.00	1.46	2.88	3.00	4.43	3.88	1.62	2.00	0.50	2.88	2.00	0.38

'DO NOT ALTER WITHOUT AGENCY NOTIFICATION'

COTI GLOBAL SENSORS, INC.

CG-26S1 COMPRESSION CANISTER
NTEP LOAD CELL

APPROVALS		DATE
DRAWN: DH		2/09/10
CHECKED: MB		2/09/10
ENGINEER: DH		2/09/10
APPROVED: AA		2/09/10
MATERIAL		
STAINLESS STEEL		

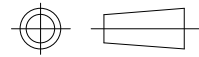

THIS DOCUMENT CONTAINS PROPRIETARY INFORMATION AND SUCH INFORMATION MAY NOT BE REPRODUCED OR DISCLOSED FOR ANY PURPOSE OR USED TO PRODUCE THE ARTICLE OR SUBJECT WITHOUT WRITTEN PERMISSION FROM COTI GLOBAL SENSORS, INC.

TOLERANCES UNLESS OTHERWISE SPECIFIED
 .XX±.01
 .XXX±.005
 FRACTIONS±1/16"
 ANGLES: ±1/2°

SCALE	SIZE	PART/DRAWING NO.	REV.
NONE	B	DOD-CG-26S1	D
MODEL CG-26S1			SHEET 1 OF 1